

# DIN3202 F6 SWING CHECK VALVE

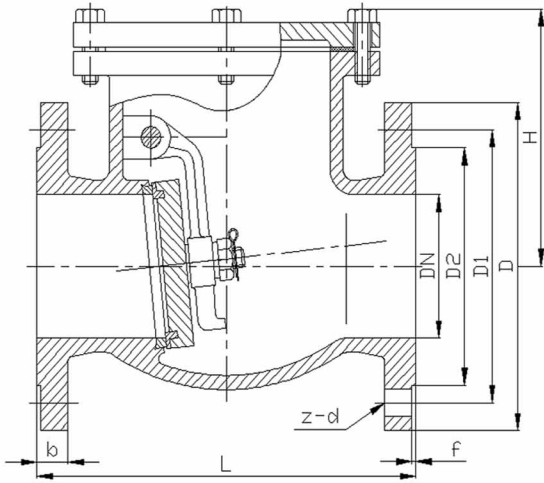
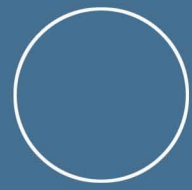

Materials of Parts	
Body	Ductile Iron to GGG50
Bonnet	Ductile Iron to GGG50
Disc	Ductile Iron to GGG50
Body seats	Brass
Disc seats	Brass
Arm	Ductile Iron to GGG50
Hinge pin	Stainless Steel to SS420
Gasket	EPDM
Bolts & Nuts	SS304 / Carbon Steel with Zinc

Dimension: PN16									mm
Size	D	D1	D2	H	L	b	f	z-d	Weight kg
DN40	150	110	84	122	180	18	3	4-Ø19	9
DN50	165	125	99	137	200	20	3	4-Ø19	13
DN65	185	145	118	147	240	20	3	4-Ø19	15
DN80	200	160	132	159	260	22	3	8-Ø19	21
DN100	220	180	156	180	300	24	3	8-Ø19	29
DN125	250	210	184	203	350	26	3	8-Ø19	42
DN150	285	240	211	223	400	26	3	8-Ø23	58
DN200	340	295	266	258	500	30	3	12-Ø23	100
DN250	405	355	319	290	600	32	3	12-Ø28	155
DN300	460	410	370	325	700	32	4	12-Ø28	200
DN350	520	470	429	361	800	36	4	16-Ø28	270
DN400	580	525	480	388	900	38	4	16-Ø31	340
DN450	640	585	548	450	1000	40	4	20-Ø31	600
DN500	715	650	609	518	1100	42	4	20-Ø34	700
DN600	840	770	720	620	1300	48	5	20-Ø37	1060

Note: The illustrations in this catalogue are subject to modifications without notice.